



LP0180

**FITTING INSTRUCTIONS FOR LP0180BK LICENCE PLATE BRACKET**  
**YAMAHA YZF R1 2015-**

Page | 1



**THIS KIT CONTAINS THE ITEMS PICTURED AND LABELLED BELOW.**  
**DO NOT PROCEED UNTIL YOU ARE SURE ALL PARTS ARE PRESENT.**

Please note that the way the kit is packed does not necessarily represent the way of mounting to the bike

THE PARTS SHOWN MAY BE REPRESENTATIVE ONLY (FOR CLARITY OF INSTRUCTIONS ONLY)

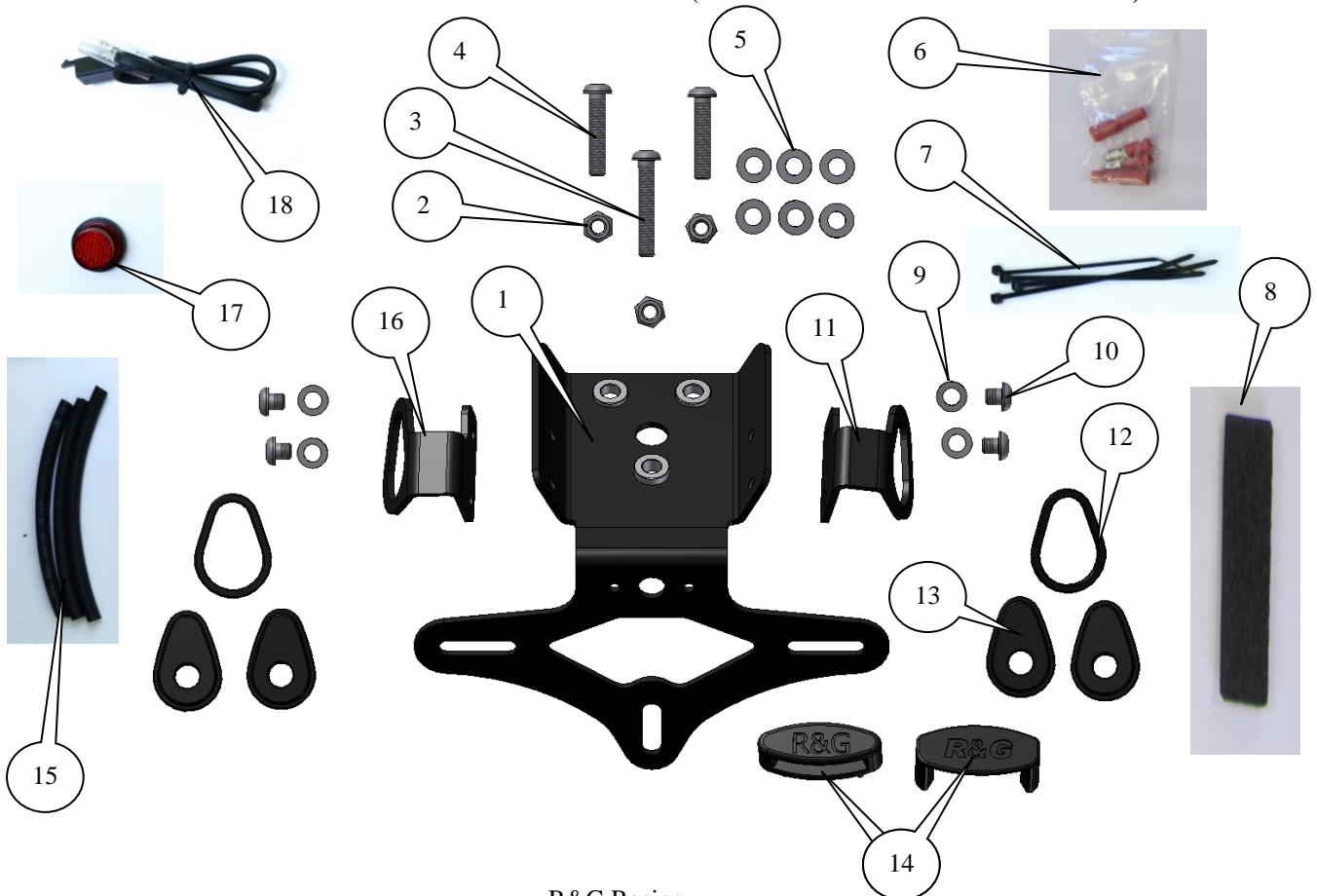

R&G Racing

Unit 1, Shelley's Lane, East Worldham, Alton, Hampshire, GU34 3AQ

Tel: +44 (0)1420 89007 Fax: +44 (0)1420 87301 [www.rg-racing.com](http://www.rg-racing.com) Email: [info@rg-racing.com](mailto:info@rg-racing.com)



LP0180

### **LEGEND**

- ITEM 1 = LICENCE PLATE MOUNTING BRACKET (TB0180BK) (x1).  
ITEM 2 = M6 NYLOC NUTS (x3).  
ITEM 3 = M6x35mm BUTTON HEAD BOLTS (x1).  
ITEM 4 = M6x30mm BUTTON HEAD BOLTS (x2).  
ITEM 5 = M6 WASHERS (16mm O/DIA) (x6).  
ITEM 6 = INDICATOR CONNECTORS (CON0004) (x2).  
ITEM 7 = CABLE TIES LONG (x3).  
ITEM 8 = SELF ADHESIVE FOAM (x4).  
ITEM 9 = M6 WASHERS (12mm O/DIA) (x4).  
ITEM 10 = M6x6mm BUTTON HEAD BOLTS (x4).  
ITEM 11 = RHS INDICATOR MOUNTING BRACKET (TB0180 PT 2) (x1).  
ITEM 12 = ORIGINAL INDICATOR SPACERS (I0037) (x2).  
ITEM 13 = MINI INDICATOR ADAPTORS (I0016) (x4).  
ITEM 14 = LICENCE PLATE ILLUMINATOR ASSEMBLY (LA0002) (x1).  
ITEM 15 = 180mm LENGTHS OF HEAT SHRINK (x3).  
ITEM 16 = LHS INDICATOR MOUNTING BRACKET (TB0180 PT 1) (x1).  
ITEM 17 = REFLECTOR (REFL 1) (x1).  
ITEM 18 = LICENCE PLATE ILLUMINATOR CONNECTOR (CON0014) (x1).  
ITEM 19 = SELF ADHESIVE CABLE CLIPS (x2) (NOT SHOWN).

Page | 2

Please note that in cases where kits are packed with rubber washers holding the components onto the bolt – *the rubber washers should be thrown away!*

### **TOOLS REQUIRED**

- Set of metric Allen keys.
- Metric Socket set.
- Phillips driver.
- Small amount of super glue.
- Electrical pliers/crimps.



PICTURE 1

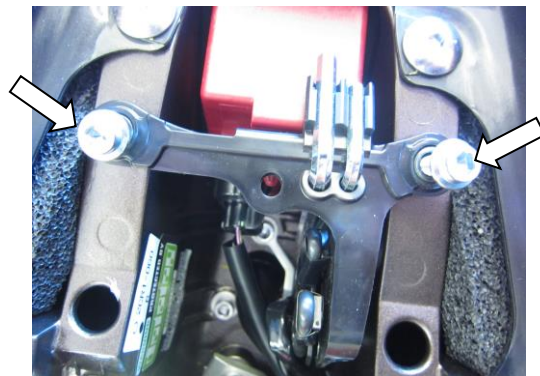

PICTURE 2



LP0180

Page | 3



PICTURE 3



PICTURE 4



PICTURE 5

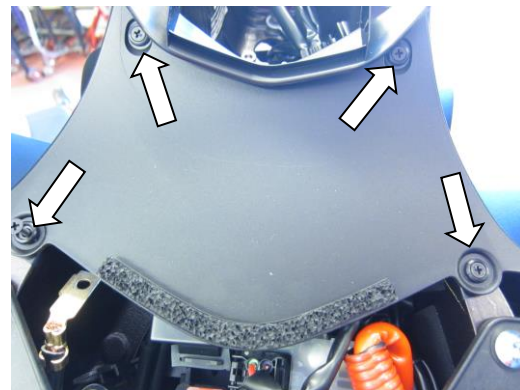

PICTURE 6

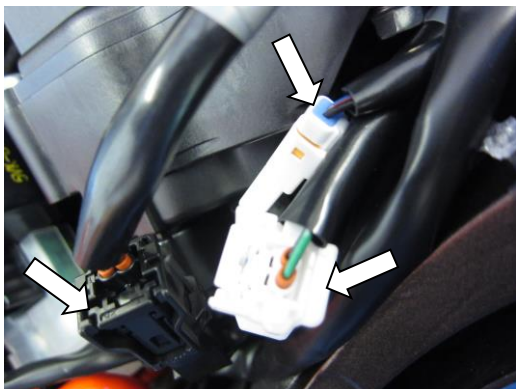

PICTURE 7

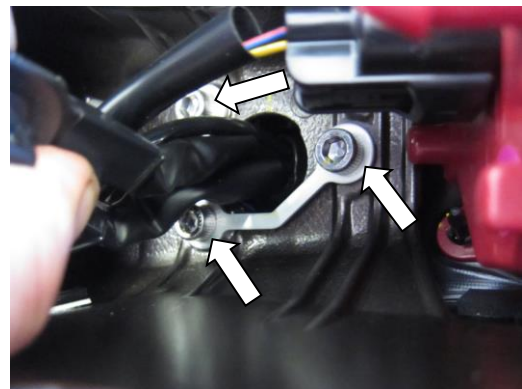

PICTURE 8





LP0180

Page | 4



PICTURE 9



PICTURE 10



PICTURE 11



PICTURE 12



PICTURE 13



PICTURE 14



LP0180

Page | 5



PICTURE 15



PICTURE 16



PICTURE 17

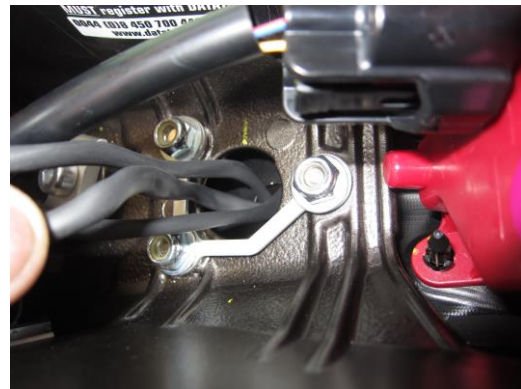

PICTURE 18

### **FITTING INSTRUCTIONS**

- Remove the pillion seat using the key as shown in picture 1.
- Remove the two bolts arrowed in picture 2 and remove the tool holder/cable bracket.
- Unclip the two wiring holders arrowed in picture 3.
- Remove the two bolts arrowed in pictures 4 and 5, and remove rider seat.
- Remove the four plastic rivets arrowed in picture 6 and remove the infill panel.
- Disconnect the indicator and licence plate illuminator wiring plug sockets arrowed in picture 7.
- Remove the three bolts that hold the original licence plate bracket from under the pillion seat as arrowed in picture 8.
- Gently remove the original licence plate bracket whilst being care to avoid snagging the wiring (it has a cable clamp that must be removed).

### **If using the original indicators**

- Remove the spreader/location plate arrowed in picture 9.
- Gently squeeze the indicator stem and remove the indicator.
- Repeat for the other indicator.
- Fit the original indicators to the new licence plate brackets (items 11 and 16) using the indicator adaptors (item 12) (in position arrowed in picture 10 so it fits in the groove in the stem and between the indicator and the bracket).

R&G Racing

Unit 1, Shelley's Lane, East Worldham, Alton, Hampshire, GU34 3AQ

Tel: +44 (0)1420 89007 Fax: +44 (0)1420 87301 [www.rg-racing.com](http://www.rg-racing.com) Email: [info@rg-racing.com](mailto:info@rg-racing.com)



LP0180

If fitting R&G mini indicators (R&G product code RG370=bulb, RG371=LED or RG372 = Aero LED

- If fitting the R&G Mini Indicators, the OEM indicator wiring will need to be “cut and shut” in order to re-use the connectors to connect the R&G Mini Indicators to the wiring loom. This is done by cutting the connectors off the OEM indicators, before fitting the bullet connectors (item 6 – CON004) to the exposed wiring and connecting to the R&G indicators. Plug it into the loom to check at this stage (if illumination fails, swap the bullet connections around). (Please use the heat-shrink (item 15) to protect the new indicator wires).
- Use the remaining CON004 (item 6), to connect to the main harness. (*If illumination fails, swap the bullet connections around*). It is a good idea at this point to turn the ignition on and check for the correct operation of all lights.
- Use the indicator adaptors (item 13) as shown in pictures 11 and 12 (use one adaptor either side of the bracket).
  
- Cut and stick the self-adhesive foam (item 8) as shown in picture 13.
- Fit the new licence plate illuminator (item 14) to the licence plate bracket assembly as shown in picture 14 (please use the provided heat shrink (item 15) to protect the wiring).
- **PLEASE NOTE YOU WILL NEED TO GLUE THE LIGHT SHROUD TO THE LED LICENCE PLATE ILLUMINATOR USING A SMALL AMOUNT OF SUPER GLUE.**

Page | 6

If fitting indicators

- With the indicators of choice fitted to the indicator mounting brackets, use the four bolts and washers (items 9 and 10) to secure in position as shown in pictures 15 and 16.
- Offer the assembly into position as original while feeding the wires through the under-tray as original and using the two shorter M6 button head bolts and washers (items 4 and 5) through the front holes (the front of the motorcycle) from underneath, use two of the nyloc nuts with washers (items 2 and 5) to secure in position as shown in pictures 17 and 18.
- Use the longer M6 button head bolt with washer (items 3 and 5) through the rear hole and secure using the remaining nut and washer (items 2 and 5) to secure in position as shown in pictures 17 and 18.
- Reconnect all the indicator wiring plug sockets and check operation (if illumination fails, swap the bullet connections around).
- Connect the licence plate illuminator using the supplied connector (item 18) (if illumination fails, swap the bullet connections around).
- Fit licence plate to new licence plate bracket (it may require re-drilling).
- **IMPORTANT: IF FITTING A FULL-SIZE LICENCE PLATE AND PLACING IT FAR DOWN ON THE LICENCE PLATE HANGER, THERE IS A SMALL CHANCE OF THE LICENCE PLATE HITTING THE BACK WHEEL UNDER HEAVY LOAD AND OVER LARGE BUMPS IN THE ROAD. IT IS YOUR RESPONSIBILITY TO CHECK FOR THIS POSSIBILITY AND TAKE AVOIDING ACTION. FAILURE TO CHECK THIS COULD RESULT IN SERIOUS INJURY.**
- Refit the tool holder/cable harness as original.
- Refit the infill panel as original.
- Refit both seats.
- Depending on local laws, attach enclosed red reflector (item 17) in an appropriate location.

R&G Racing

Unit 1, Shelley's Lane, East Worldham, Alton, Hampshire, GU34 3AQ

Tel: +44 (0)1420 89007 Fax: +44 (0)1420 87301 [www.rg-racing.com](http://www.rg-racing.com) Email: [info@rg-racing.com](mailto:info@rg-racing.com)



LP0180

- **Please test the indicators, rear light and licence plate illuminator before riding.**

**Digital copies of these instructions are available to download from [www.rg-racing.com](http://www.rg-racing.com)**

Page | 7

#### **GENERAL TORQUE SETTINGS**

M4 BOLT = 8Nm  
M5 BOLT = 12Nm  
M6 BOLT = 15Nm  
M8 BOLT = 20Nm  
M10 BOLT = 40Nm

ISSUE 2 12/0/2015 (NSY)

#### **CONSUMER NOTICE**

The catalogue description and any exhibition of samples are only broad indications of the Products and R&G may make design changes which do not diminish their performance or visual appeal and supplying them in such state shall conform to the order. The Buyer acknowledges no representation or warranty (other than as to title) has been given or will apply to the Products other than those in R&G's order or confirmation and the Buyer confirms it has chosen the Products as being of merchantable quality and suitable for its particular purposes. Where R&G fits the Products or undertakes other services it shall exercise reasonable skill and care and rectify any fault free of charge unless the workmanship has been disturbed. The Buyer is responsible for ensuring that the warranty on the motorcycle is not affected by the fitting of the Products. On return of any defective Products R&G shall at its option either supply a replacement or refund the purchase money but shall not be liable if the Products have been modified or used or maintained otherwise than in accordance with R&G's or manufacturer's instructions and good engineering practice or if the defect arises from accident or neglect. Other than identified above and subject to R&G not limiting its liability for causing death and personal injury, it shall not be liable for indirect or consequential loss and otherwise its liability shall be limited to the amounts paid by the Buyer for the Products or the fitting or service concerned. These terms do not affect the Buyer's statutory rights.

#### **R&G RACING RETURNS POLICY (NON-FAULTY GOODS)**

Returns must be pre-authorized (if not pre-authorized the return will be rejected). Goods may only be returned direct to us if they were purchased direct from us (customer must prove if necessary). Otherwise to be returned to original vendor. Goods must be in re-sellable condition, in the opinion of R&G Racing. All returns are subject to a 25% restocking and handling fee (25% of the gross value exc. P&P – at the prevailing price at time of purchase). The customer must pay any and all carriage charges. No returns of discontinued products, unless within 14 days of purchase. This policy does not affect your statutory rights and does not refer to faulty goods.

R&G Racing

Unit 1, Shelley's Lane, East Worldham, Alton, Hampshire, GU34 3AQ

Tel: +44 (0)1420 89007 Fax: +44 (0)1420 87301 [www.rg-racing.com](http://www.rg-racing.com) Email: [info@rg-racing.com](mailto:info@rg-racing.com)





LP0180

**INSTRUCTIONS DE MONTAGE POUR LP0180BK SUPPORT DE PLAQUE**  
**YAMAHA YZF R1 2015-**

Page | 8



**Assurez vous que toutes les pièces soient présentes avant de procéder au montage.**

**La façon dont le kit est emballé ne correspond pas forcément à la façon de monter les pièces sur la moto.**

LES PIÈCES PRÉSENTÉES PEUVENT N'ÊTRE QUE REPRESENTATIVES, AFIN DE FACILITER ET CLARIFIER LES INSTRUCTIONS DE MONTAGE

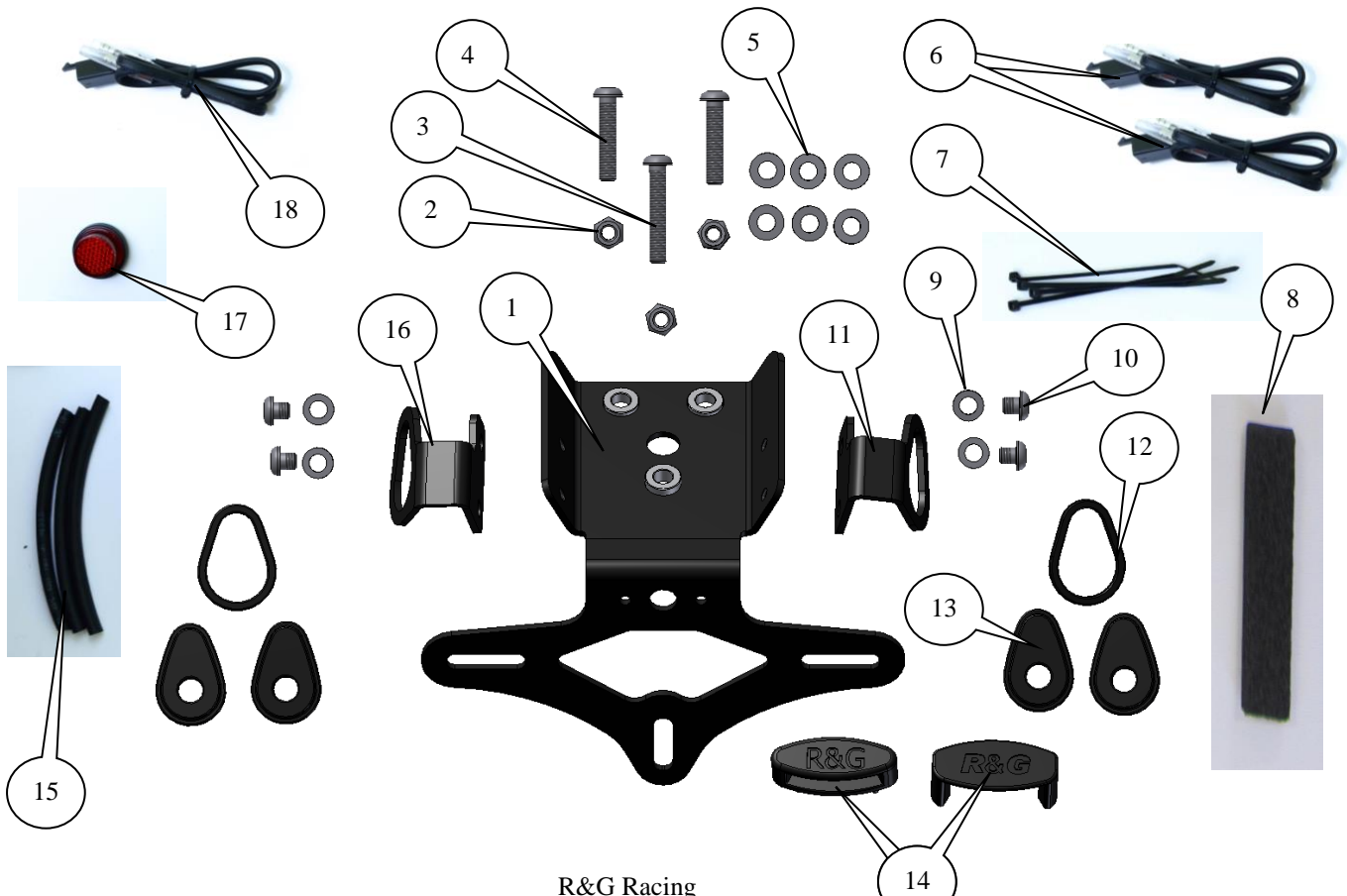





LP0180

### **LEGENDE**

- ARTICLE 1 = SUPPORT DE PLAQUE (TB0180BK) (x1).  
ARTICLE 2 = M6 ECROUS (x3).  
ARTICLE 3 = M6x35mm BOULONS (x1).  
ARTICLE 4 = M6x30mm BOULONS (x2).  
ARTICLE 5 = M6 RONDELLES (16mm O/DIA) (x6).  
ARTICLE 6 = CONNECTEURS DE CLIGNOTANTS (CON0004) (x2).  
ARTICLE 7 = COLLIERS DE CABLAGE (x3).  
ARTICLE 8 = MOUSSE AUTOCOLLANTE (x4).  
ARTICLE 9 = M6 RONDELLES (12mm O/DIA) (x4).  
ARTICLE 10 = M6x6mm BOULONS (x4).  
ARTICLE 11 = SUPPORT CLIGNOTANT DROIT (TB0180 PT 2) (x1).  
ARTICLE 12 = ENTRETROISES CLIGNOTANTS D'ORIGINE (I0037) (x2).  
ARTICLE 13 = ADAPTATEURS MINI CLIGNOTANTS (I0016) (x4).  
ARTICLE 14 = ASSEMBLAGE FEU DE PLAQUE (LA0002) (x1).  
ARTICLE 15 = 180mm LONGUEURS DE THERMORETRACTABLES (x3).  
ARTICLE 16 = SUPPORT CLIGNOTANT GAUCHE (TB0180 PT 1) (x1).  
ARTICLE 17 = REFLECTEUR (REFL 1) (x1).  
ARTICLE 18 = CONNECTEUR FEU DE PLAQUE (CON0014) (x1).  
ARTICLE 19 = CLIPS AUTOCOLLANTS (x2) (NON INDIQUE).

Page | 9

Notez que si les kits sont emballés avec des rondelles en caoutchouc servant à tenir les composants, *ces rondelles doivent être jetées.*

### **OUTILS REQUIS**

- Jeu de clés Allen.
- Clé métrique.
- Tournevis cruciforme.
- Un peu de superglue.
- Pincés électriques.



PHOTO 1

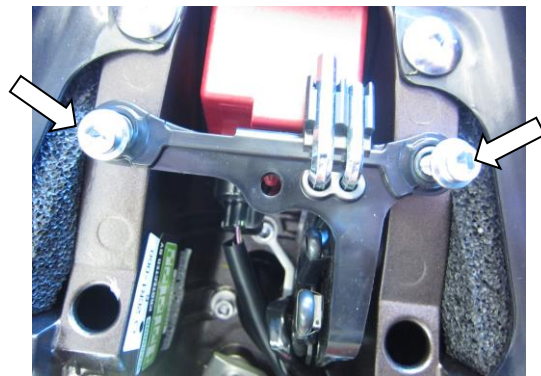

PHOTO 2

R&G Racing

Unit 1, Shelley's Lane, East Worldham, Alton, Hampshire, GU34 3AQ  
Tel: +44 (0)1420 89007 Fax: +44 (0)1420 87301 [www.rg-racing.com](http://www.rg-racing.com) Email: [info@rg-racing.com](mailto:info@rg-racing.com)



LP0180

Page | 10



PHOTO 3



PHOTO 4



PHOTO 5

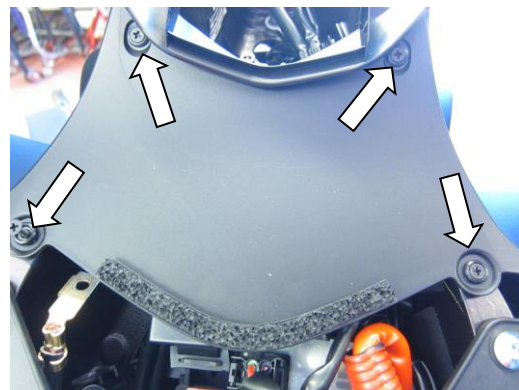

PHOTO 6

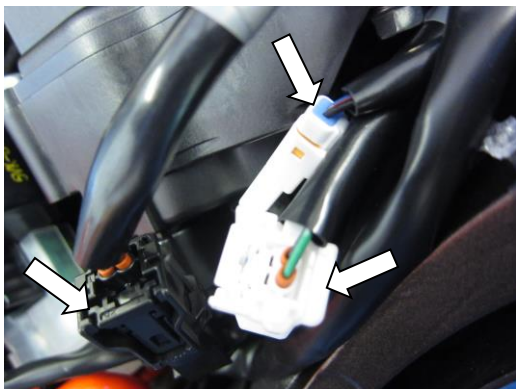

PHOTO 7

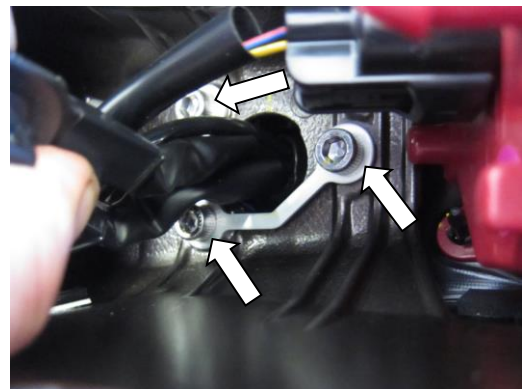

PHOTO 8



LP0180

Page | 11



PHOTO 9



PHOTO 10



PHOTO 11



PHOTO 12



PHOTO 13



PHOTO 14

R&G Racing  
Unit 1, Shelley's Lane, East Worldham, Alton, Hampshire, GU34 3AQ  
Tel: +44 (0)1420 89007 Fax: +44 (0)1420 87301 [www.rg-racing.com](http://www.rg-racing.com) Email: [info@rg-racing.com](mailto:info@rg-racing.com)





LP0180

Page | 12



PHOTO 15



PHOTO 16



PHOTO 17

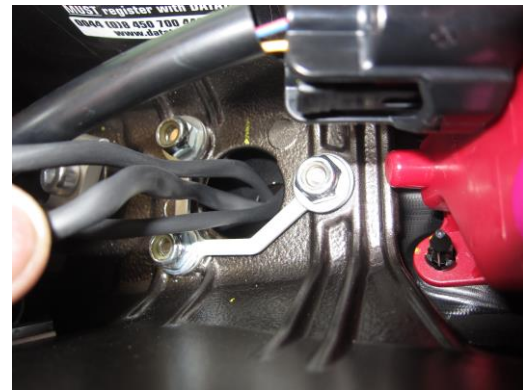

PHOTO 18

### **INSTRUCTIONS DE MONTAGE**

- Enlever le siège passager à l'aide de la clé, voir photo 1.
- Enlever les deux boulons indiqués sur la photo 2 puis enlever le support d'outil/support câble.
- Déclipser les 2 supports de fils, voir photo 3.
- Enlever les 2 boulons indiqués sur les photos 4 et 5, puis enlever le siège pilote.
- Enlever les 4 rivets en plastique indiqués sur la photo 6 puis enlever le cache interne.
- Déconnecter les prises de fils de feu de plaque, indiquées sur la photo 7.
- Enlever les 3 boulons qui maintiennent le support de plaque d'origine par le dessous du siège passager, voir photo 8.
- Enlever délicatement le support de plaque tout en faisant attention aux fils (il y a un attache câble qui doit être enlevé).

### **Si vous utilisez les clignotants d'origine**

- Enlever l'écarteur/ la plaque indiqués sur la photo 9.

R&G Racing  
Unit 1, Shelley's Lane, East Worldham, Alton, Hampshire, GU34 3AQ  
Tel: +44 (0)1420 89007 Fax: +44 (0)1420 87301 [www.rg-racing.com](http://www.rg-racing.com) Email: [info@rg-racing.com](mailto:info@rg-racing.com)



LP0180

- Appuyez doucement sur la tige de clignotant puis enlever le clignotant.
- Répéter la procédure pour l'autre clignotant.
- Monter les clignotants d'origine sur les nouveaux supports de plaque (articles 11 et 16) en utilisant les adaptateurs de clignotant (article 12) (en position indiquée sur la photo 10, de façon à ce qu'ils se place dans la rainure de la tige et entre le clignotant et le support).

Page | 13

Si vous installez des mini clignotants R&G (R&G code produit RG370=ampoule, RG371=LED ou RG372 = LED latérale

- Si le montage du R & G Mini indicateurs , le câblage de l'indicateur OEM devra être " coupé et fermé " afin de ré - utiliser les connecteurs pour relier les R & G Mini Indicateurs au câblage. Cela se fait en coupant les connecteurs hors les indicateurs OEM , avant de monter les connecteurs de balles (article 6 - CON0004 ) pour le câblage exposé et la connexion à des indicateurs de R & G . Branchez-le sur le métier à tisser à vérifier à ce stade (si l'éclairage échoue, permuter les connexions de balles autour ) . ( S'il vous plaît utiliser le - thermorétractable (article 15 ) pour protéger les nouveaux fils de l'indicateur ) .
- Utilisez la CON004 (article 6 ) restant , pour se connecter au faisceau principal . ( Si l'éclairage échoue, permuter les connexions de balles autour ) .Il est une bonne idée à ce stade de mettre le contact et vérifier le bon fonctionnement de toutes les lumières .
- Utilisez les adaptateurs d'indicateurs (article 13 ) , comme illustré dans les images 11 et 12 ( utiliser une carte de chaque côté de la console ) .Couper et coller la mousse autocollante (article 8), voir photo 13.
- Monter le nouveau de plaque (article 14) à l'assemblage de feu de plaque, voir photo 14 (Utiliser la gaine thermo rétractable fournie (article 15) pour protéger les fils).
- **VOUS DEVREZ COLLER LE LINCEUL DE FEU AU FEU DE PLAQUE LED A L'AIDE DE LA SUPERGLUE.**

Si vous installez des clignotants classiques :

- Une fois les clignotants de votre choix installés sur le support de fixation, utiliser les 4 boulons et rondelles (articles 9 et 10) pour fixer la position, voir photos 15 et 16.
- Monter l'ensemble comme à l'origine tout en passant les fils dans le passage de roue comme à l'origine et en utilisant les 2 boulons M6 et rondelles (articles 4 et 5) dans les trous avant (l'avant de la moto) from underneath, use two of the écrous with rondelles (articles 2 and 5) to secure in position as shown in photos 17 and 18.
- Use the longer M6 boulon with washer (articles 3 and 5) through the rear hole and secure using the remaining nut and washer (articles 2 and 5) to secure in position as shown in photos 17 and 18.
- Reconnect all the indicator wiring plug sockets and check operation (if illumination fails, swap the bullet connections around).
- Connect the licence plate illuminator using the supplied connector (article 18) (if illumination fails, swap the bullet connections around).
- Fit licence plate to new licence plate bracket (it may require re-drilling).
- **IMPORTANT: Si vous installez une grosse plaque, il y a un risque que la plaque entre en contact avec la roue arrière en cas de choc sur la route (bosse, grosse charge etc...). Il est de votre responsabilité de vérifier que cela ne puisse pas se produire. Ne pas effectuer ces vérifications peut entraîner des dommages ainsi que des blessures graves pour le pilote.**
- Remettre le porte outil / harnais comme à l'origine.
- Remettre le cache interne comme à l'origine.

R&G Racing

Unit 1, Shelley's Lane, East Worldham, Alton, Hampshire, GU34 3AQ

Tel: +44 (0)1420 89007 Fax: +44 (0)1420 87301 [www.rg-racing.com](http://www.rg-racing.com) Email: [info@rg-racing.com](mailto:info@rg-racing.com)



LP0180

- Remettre les deux sièges.
- Selon la loi locale, monter les réflecteurs (article 17) aux emplacements appropriés.
- Revérifiez que les clignotants et les feux de plaque fonctionnent bien avant de prendre la route.

Page | 14

**Ces instructions de montage sont disponibles sur [www.rg-racing.com](http://www.rg-racing.com)**

### **COUPLES DE SERRAGE GÉNÉRAUX**

M4 BOULON = 8Nm  
M5 BOULON = 12Nm  
M6 BOULON = 15Nm  
M8 BOULON = 20Nm  
M10 BOULON = 40Nm

ISSUE 1 12/05/2015 (NSY)

### **CONSUMER NOTICE**

The catalogue description and any exhibition of samples are only broad indications of the Products and R&G may make design changes which do not diminish their performance or visual appeal and supplying them in such state shall conform to the order. The Buyer acknowledges no representation or warranty (other than as to title) has been given or will apply to the Products other than those in R&G's order or confirmation and the Buyer confirms it has chosen the Products as being of merchantable quality and suitable for its particular purposes. Where R&G fits the Products or undertakes other services it shall exercise reasonable skill and care and rectify any fault free of charge unless the workmanship has been disturbed. The Buyer is responsible for ensuring that the warranty on the motorcycle is not affected by the fitting of the Products. On return of any defective Products R&G shall at its option either supply a replacement or refund the purchase money but shall not be liable if the Products have been modified or used or maintained otherwise than in accordance with R&G's or manufacturer's instructions and good engineering practice or if the defect arises from accident or neglect. Other than identified above and subject to R&G not limiting its liability for causing death and personal injury, it shall not be liable for indirect or consequential loss and otherwise its liability shall be limited to the amounts paid by the Buyer for the Products or the fitting or service concerned. These terms do not affect the Buyer's statutory rights.

### **R&G RACING RETURNS POLICY (NON-FAULTY GOODS)**

Returns must be pre-authorized (if not pre-authorized the return will be rejected). Goods may only be returned direct to us if they were purchased direct from us (customer must prove if necessary). Otherwise to be returned to original vendor. Goods must be in re-sellable condition, in the opinion of R&G Racing. All returns are subject to a 25% restocking and handling fee (25% of the gross value exc. P&P – at the prevailing price at time of purchase). The customer must pay any and all carriage charges. No returns of discontinued products, unless within 14 days of purchase. This policy does not affect your statutory rights and does not refer to faulty goods.

R&G Racing

Unit 1, Shelley's Lane, East Worldham, Alton, Hampshire, GU34 3AQ

Tel: +44 (0)1420 89007 Fax: +44 (0)1420 87301 [www.rg-racing.com](http://www.rg-racing.com) Email: [info@rg-racing.com](mailto:info@rg-racing.com)